

MOUNT ATTACHED BY ADHESIVE APPLIED TO THIS SURFACE.

OPTIONAL PRIMER THIS SURFACE

SELF-ACTUATING PRESSURE SENSITIVE ADHESIVE FIXTURE HOLDS MOUNT IN POSITION WHILE ADHESIVE CURES.

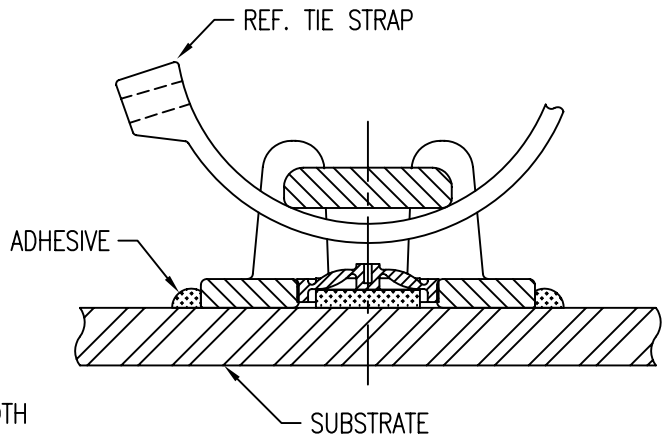
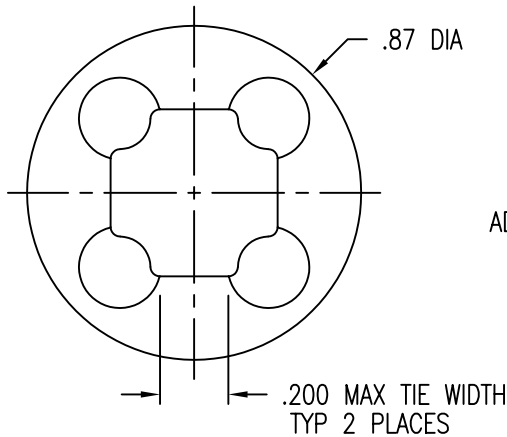

MATERIAL AND FINISH DATA

| CODE | MATERIAL | FINISH |
|------|----------------------|----------------|
| V | GLASS/POLYETHERIMIDE | ABRASIVE CLEAN |

OPTIONAL BASEPLATE PRIMER

| CODE | MATERIAL SPEC. |
|------|----------------|
| P | MIL-PRF-85582 |

APPROXIMATE WEIGHT DATA

| PART NUMBER | WEIGHT (LB/100) | WEIGHT (GRAMS) |
|-------------|-----------------|----------------|
| CB4063V3P | .46 | 2.1 |

EXAMPLE PART NUMBER

CB4063 V 3 P

↑ BASIC PART NUMBER
 ↑ MATERIAL - GLASS/POLYETHERIMIDE
 ↑ SIZE CODE
 ↑ OPTIONAL BASEPLATE PRIMER

UNLESS OTHERWISE SPECIFIED, ALL DIMENSIONS ARE IN INCHES AND TOLERANCES ARE AS SHOWN BELOW. DIMENSIONAL TOLERANCES AND SYMBOLS PER ANSI Y14.5M-1982.

PROPRIETARY PARTS SHOWN IN THIS DRAWING ARE THE SUBJECT OF ISSUED UNITED STATES AND FOREIGN PATENTS AND PATENTS PENDING. UNAUTHORIZED REPRODUCTION AND/OR DISTRIBUTION OF THIS DRAWING IS SPECIFICALLY PROHIBITED.

GLICK BOND

CARSON CITY
NEVADA 89706

| | | APPROVALS | DATE |
|--------|-------|------------------------|--------|
| ANGLES | ±1° | DRAWN <i>DAC</i> | 8FEB06 |
| .XX | ±.03 | CHECKED <i>DOC/mtm</i> | 8FEB06 |
| .XXX | ±.010 | RELEASED <i>CGH</i> | 8FEB06 |
| .XXXX | ±.001 | REVISED | |

| TITLE | | | |
|---------------------------|------------|----------|--------------|
| MOUNT, CABLE TIE, TWO WAY | | | |
| SIZE | CAGE CODE | DWG. NO. | REV. |
| A | 66530 | CB4063 | 0 |
| SCALE | 2/1 8FEB06 | | SHEET 1 OF 1 |